

# SWITCH BOARD

# RS-142

**Note:** For operation of the units, refer to the N-8000 series operating instructions.

## 1. GENERAL DESCRIPTION

The RS-142 is a switch board to be connected to the 2-Core Shielded Substation Interface Unit. You can make desired switch panels to meet intended purposes by combining the RS-142 with the separately prepared operation panel having 2 switches to be used as call buttons.

The RS-142 features handset conversations by using the RS-141 indoor-use Option Handset in combination.

## 2. CONNECTIONS

### 2.1. When the Option Handset Is Not Used

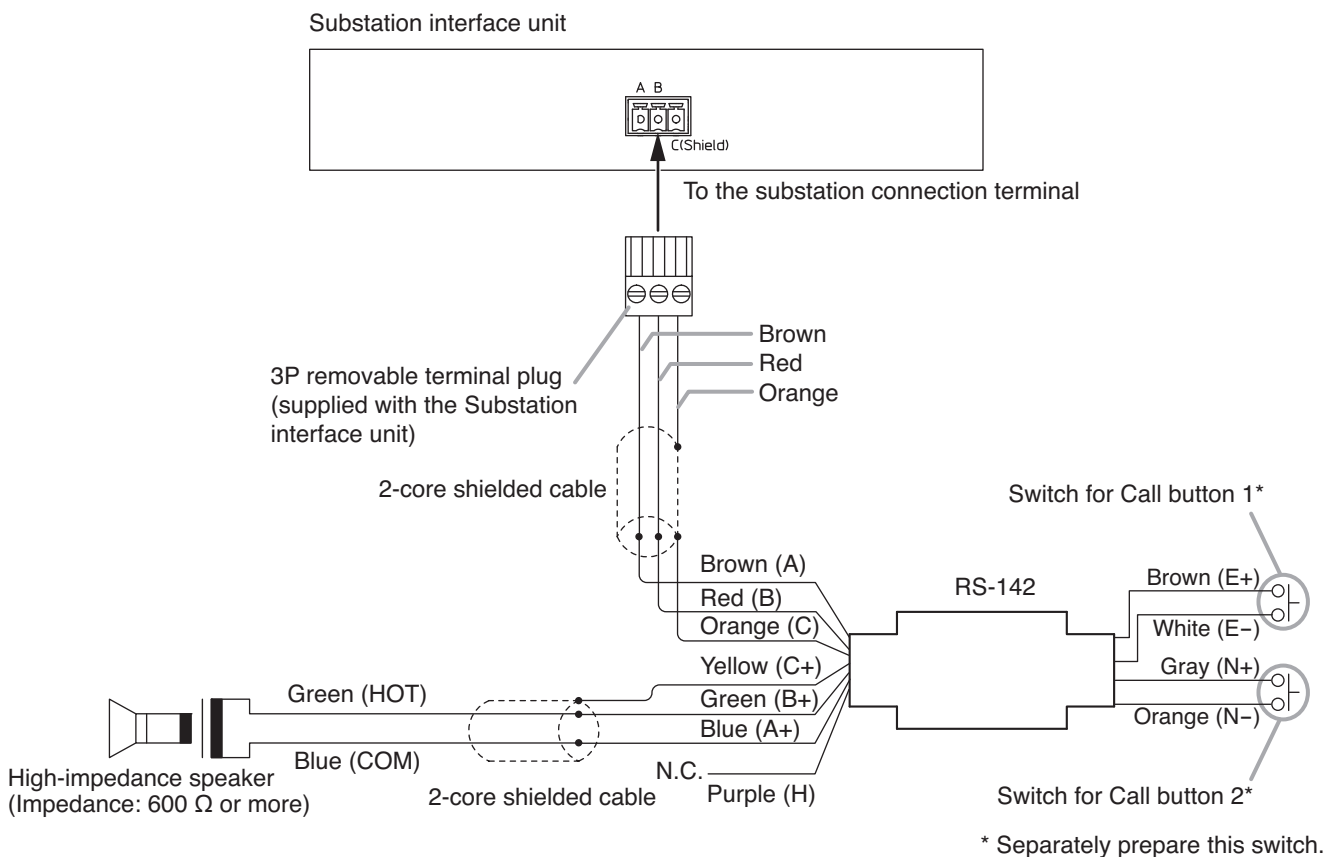

**Note**

Cut out the unused Wire (purple) to avoid short-circuiting.

### 2.3. When the Option Handset Is Used in Combination

Substation interface unit

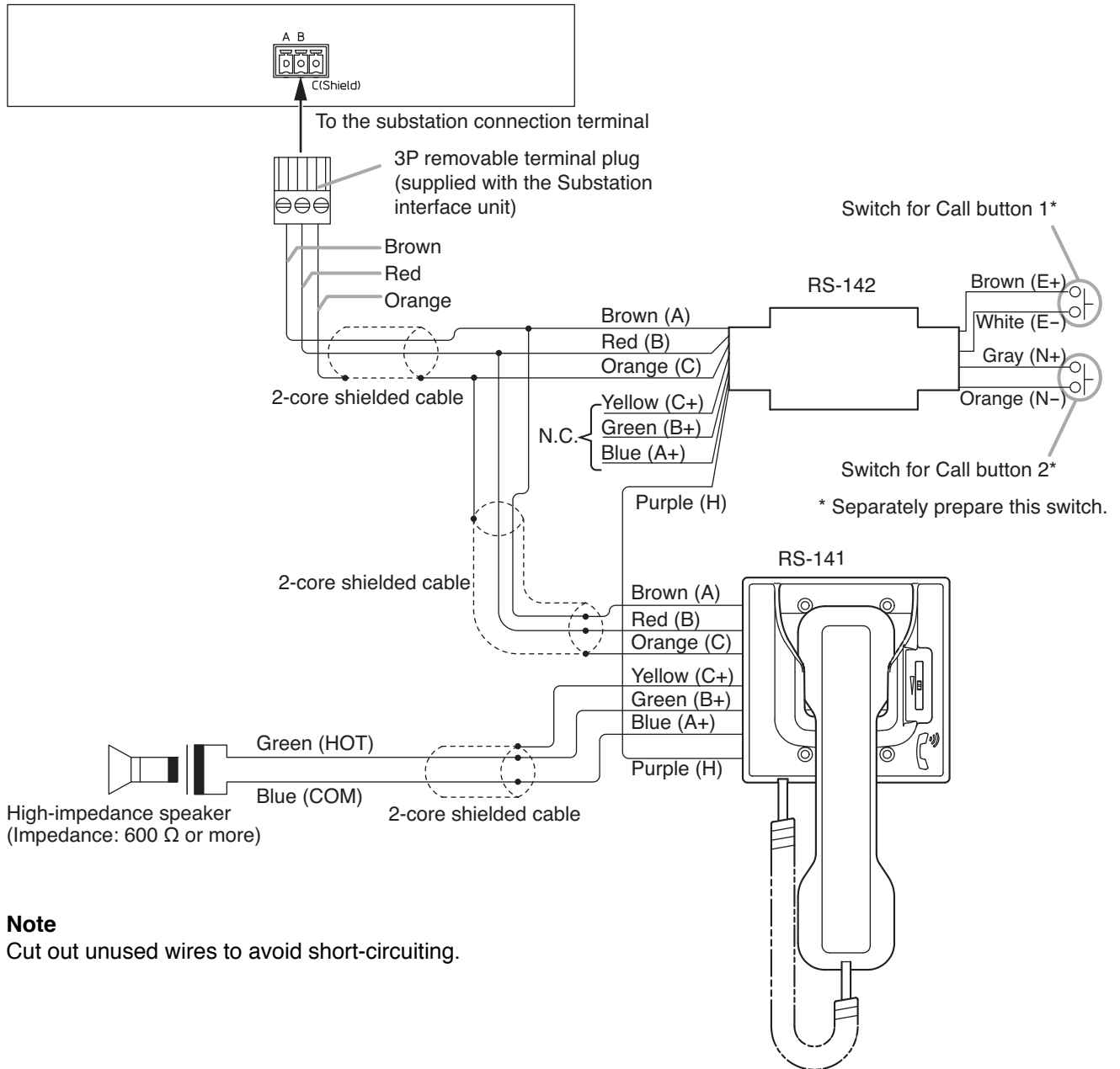

### 3. INSTALLATION

#### 3.1. Switch Board Installation

##### 3.1.1. Dimensional diagram

Unit: mm

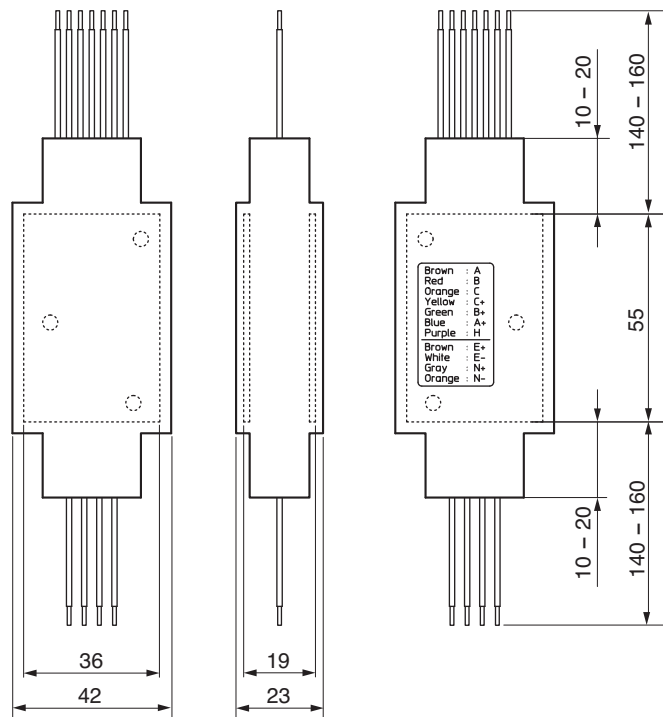

##### 3.1.2. When Making the Switch Panel to Be Combined with an Electrical Box

Put the RS-142 in the YC-801 Flush-mount box mounted in the wall.  
Then, connect the cables from RS-142 to the switches mounted on the operation panel separately prepared.

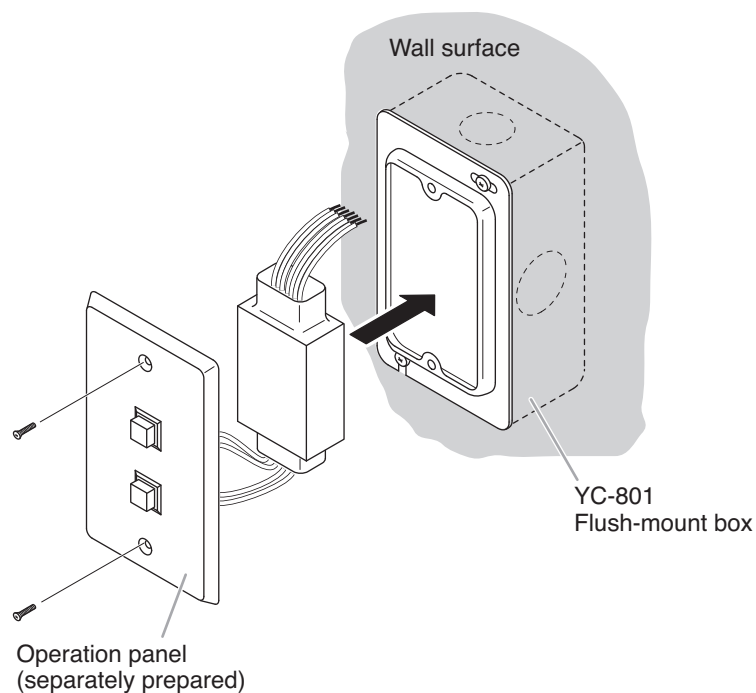

#### Note

When using the PA paging function, keep the switch panel as far away from the PA paging speaker as possible to avoid acoustic feedback.

### 3.2. Option Handset Installation

Mount the option handset to an electrical box mounted in the wall.

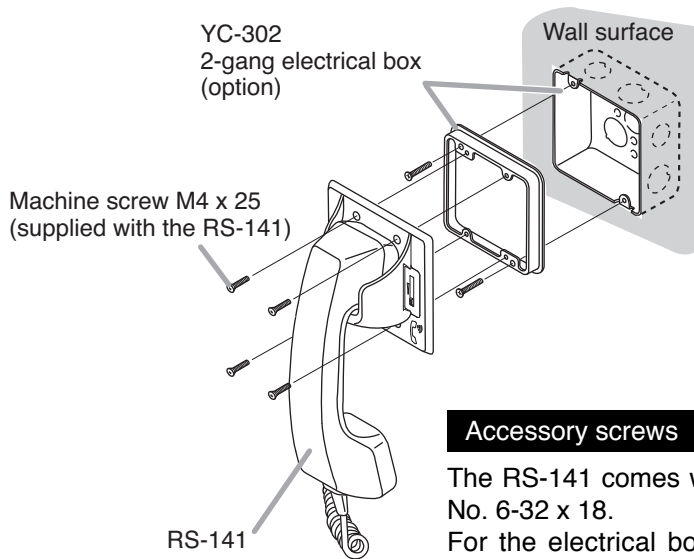

#### Accessory screws

The RS-141 comes with 2 types of screws: M4 x 25 and UNC No. 6-32 x 18.  
For the electrical box provided with unified threads, use the UNC No. 6-32 x 18.

#### [Dimensional diagram]

Unit: mm

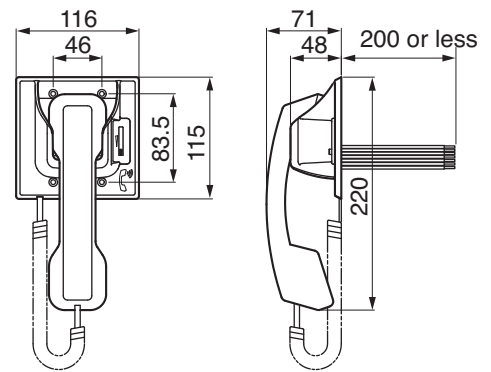

### 4. SPECIFICATIONS

Call Button Wiring	4 cables (for 2 momentary switches)
Wiring	2-core shielded cable
Transmission Range	500 m/ø0.5 mm (AWG24), 800 m/ø0.65 mm (AWG22), 1300 m/ø0.9 mm (AWG19)
Operating Temperature	0 to +40°C
Weight	30 g